

29.2180.01.0241

RENAULT MASTER & VAUXHALL MOVANO FUEL TEE-PIECE CONNECTION INCLUDING FUEL PRESSURE REDUCTION VALVE (FPR VALVE)

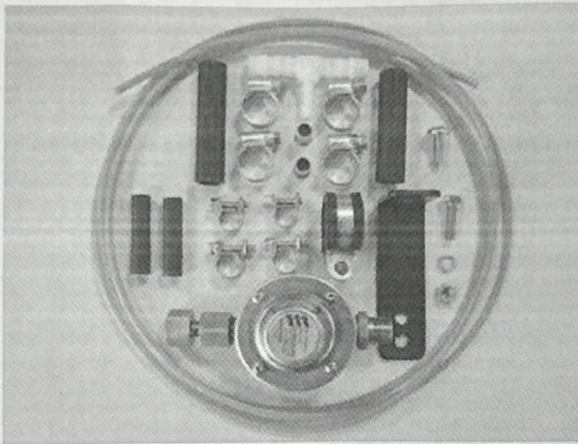

PART NUMBER	DESCRIPTION	QTY
262.31.152	Plastic Tee-Piece	1
22.1000.20.0800	FPR Valve – Includes 2 Pot Filters	1
29.2100.17.1004	9mm Clip	4
29.2100.01.1034	20mm P-Clip	1
25.1888.80.0102	6-4mm Reducer	2
29.2100.01.9167	Angle Bracket	1
890.31.054	2mm Fuel Line	2m
22.1000.20.0300	Sleeve Insert 10mm	2
81.1804.05.0249	Clip Jubilee 11-16	2
360.75.404	Hose Fuel 9mm ID 60mm	4

FUEL METERING PUMP AND PRESSURE REGULATOR ASSEMBLY

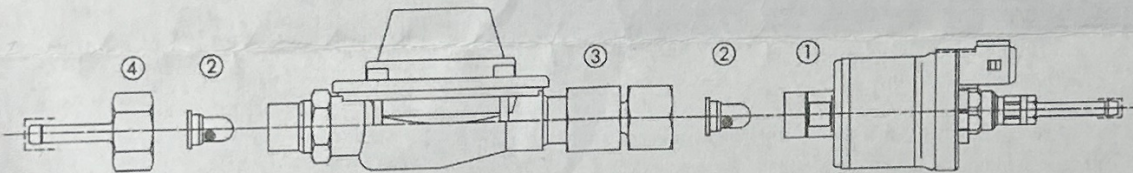

- 1 Fuel Metering Pump
- 2 Pot-Type Strainer
- 3 Pressure Regulator
- 4 Connection



IMPORTANT!

Do not fit tee-piece into vehicle fuel line until the heater's fuel line is connected to the fuel metering pump assembly.

STAGE 1 – FUEL METERING PUMP ASSEMBLY

Using a 12mm and 17mm spanner, remove the intake spigot from the fuel metering pump (FMP) and discard the pot-type strainer.

Insert the two new pot strainers into the FMP and FPR valve. Fit the FPR valve to the intake of the FMP in place of the original connector (tightening torque 21 +5 / -0 Nm).

Fit the original FMP spigot to the FPR valve (tightening torque 10 +1 / -0 Nm).

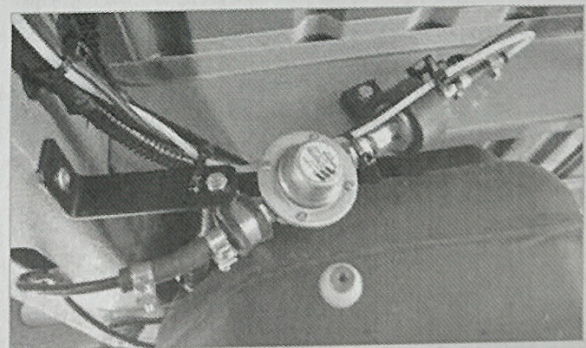

Figure 1

29.2180.01.0241

RENAULT MASTER & VAUXHALL MOVANO FUEL TEE-PIECE CONNECTION INCLUDING FUEL PRESSURE REDUCTION VALVE (FPR VALVE)

Using the supplied brackets, fasten the assembly to the underside of the vehicle in the suggested position on the chassis cross member behind the fuel tank, as shown in *Figures 1 and 2*.

Ensure that the FMP assembly is mounted at an angle of between 15° and 35°.

STAGE 2 – TEE-PIECE CONNECTION

Fasten the blue fuel line to the plastic tee-piece using a 6-4mm reducer and 2 x 9mm fuel clips.

Fit the fuel connection hoses (9mm ID x 60mm) onto the tee-piece using a suitable lubricant and fasten using two of the 11-16mm jubilee clips, as shown in *Figure 3*.

Attach the blue fuel line to the FMP assembly using the remaining 6-4mm reducer and 9mm fuel clips.



IMPORTANT!

Do not use side cutters or any other unspecified tool to cut the fuel line.

Cut the vehicle's **Black 10mm Return** fuel line, using a set of pipe cutters, just in front of the fuel tank on the inside of the chassis, as shown in *Figure 3*.

Insert the two 10mm pipe insert sleeves into both sides of the cut, this is to avoid collapsing the fuel line when tightening the clips.

Push the original fuel lines into the connection hose, ensuring that the fuel line is butted up to the tee-piece, and fasten using the remaining 11-16mm jubilee clips, as shown in *Figure 4*.



IMPORTANT!

Ensure clips are aligned with pipe insert sleeves.

Please Note!

Due to the additional FPR valve, bleeding the heater fuel system will take longer than usual.

Always ensure the tee-piece is pointing in a downward orientation and that the fuel line is fastened securely, so that no fittings or fastenings are able to chaff on the existing OEM cables, pipework or components. If in doubt during this installation please check with Eberspächer UK.

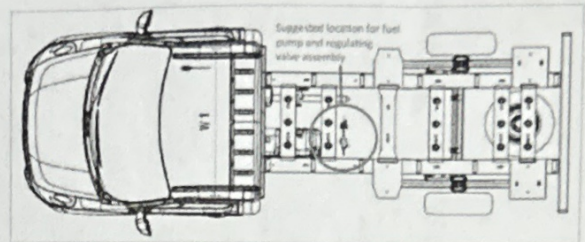

Figure 2

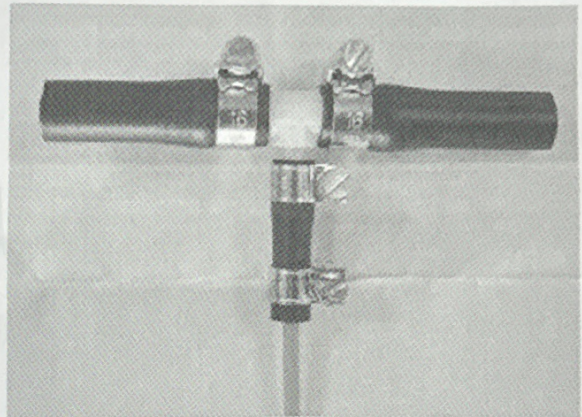

Figure 3

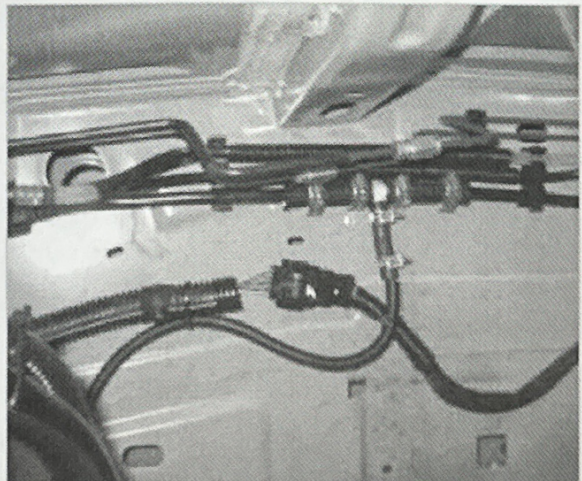

Figure 4